

PROFILE
 Scale: Vert. 1" = 4'

GENERAL NOTES

1. All work indicated on this plan shall be done in accordance with the specifications for sewer construction, City of San Bernardino, Drawing No. 8331, or file in the Office of the City Engineer.
2. All work shall be done in accordance with the specifications for sewer construction, City of San Bernardino, Drawing No. 8331, or file in the Office of the City Engineer.
3. The contractor shall be responsible for obtaining all necessary permits and for securing the location of all underground utilities.
4. The contractor shall be responsible for obtaining all necessary permits and for securing the location of all underground utilities.
5. The contractor shall be responsible for obtaining all necessary permits and for securing the location of all underground utilities.
6. The contractor shall be responsible for obtaining all necessary permits and for securing the location of all underground utilities.
7. The contractor shall be responsible for obtaining all necessary permits and for securing the location of all underground utilities.
8. The contractor shall be responsible for obtaining all necessary permits and for securing the location of all underground utilities.
9. The contractor shall be responsible for obtaining all necessary permits and for securing the location of all underground utilities.
10. The contractor shall be responsible for obtaining all necessary permits and for securing the location of all underground utilities.

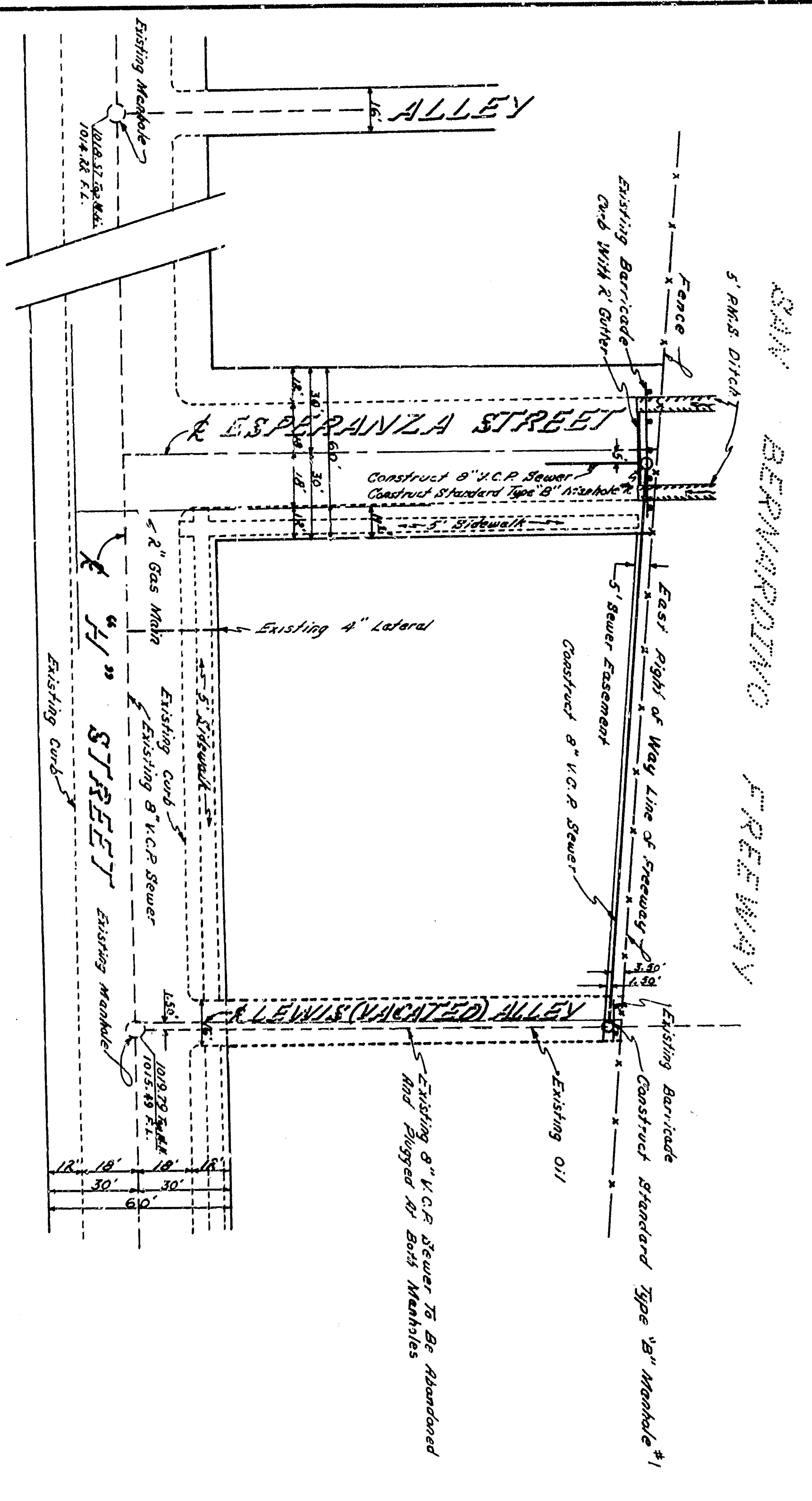

PLAN
 Scale: 1" = 40'

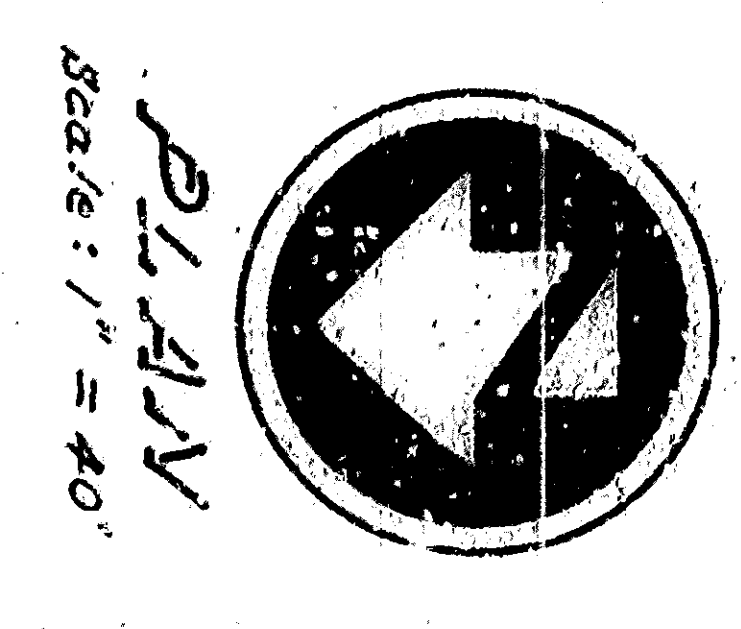
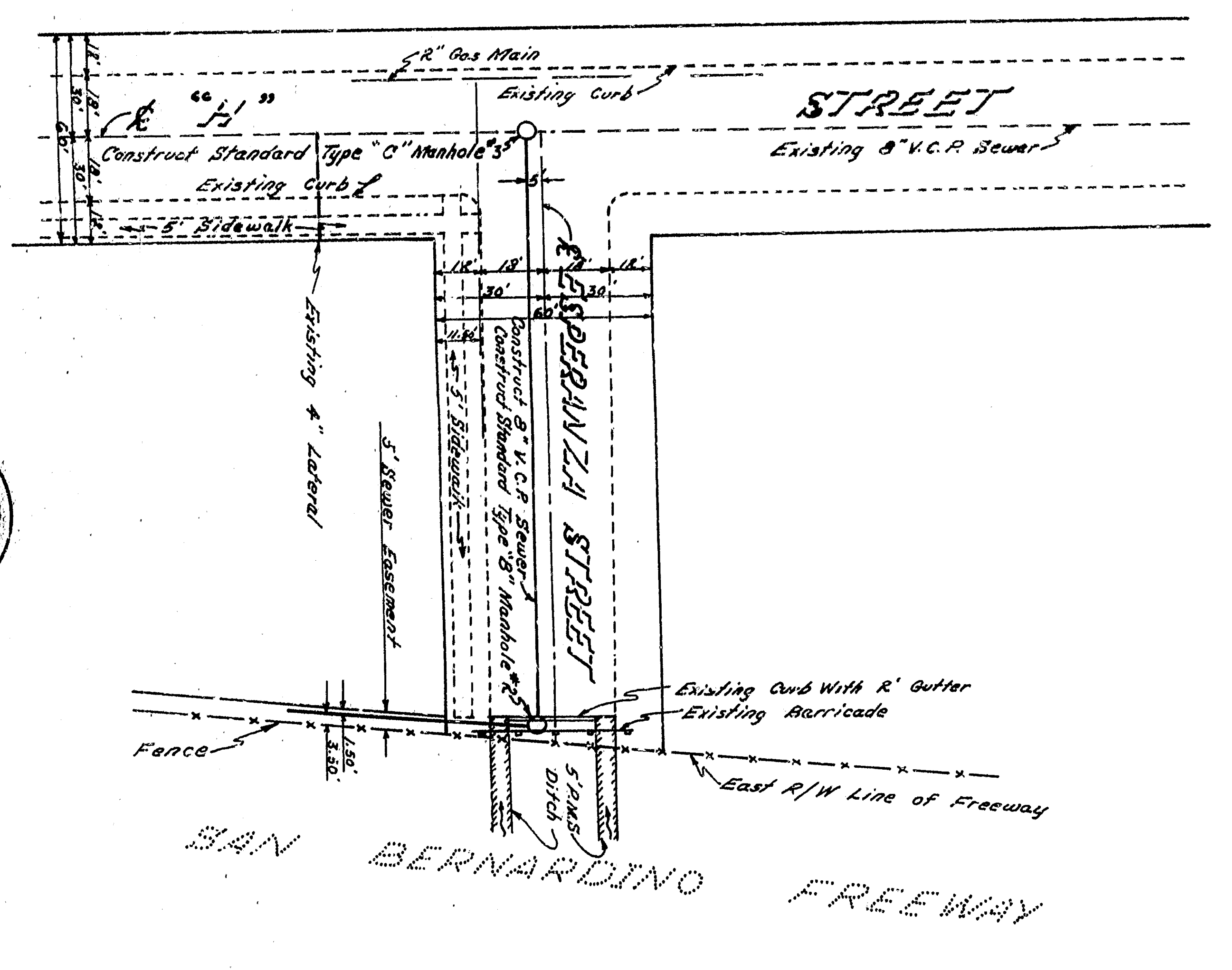

PLAN
 Scale: 1" = 40'

APPROVED	July 22, 1964	CITY OF SAN BERNARDINO DEPARTMENT OF ENGINEERING
CITY ENGINEER		
REGISTERED CIVIL ENGINEER NO. 15882		SEWER RELOCATION WEST OF "H" STREET BETWEEN LEWIS ALLEY & ESPERANZA STREET
DRAWING NO. DRAWN BY NAME		
3137		
CHECKED BY	DEAN	
SHEET 1 OF 1 SHEETS		



PROFILE
 Scale: Vert. 1" = 4'

GENERAL NOTES

1. All work shall be done in accordance with the specifications for sewerage works, City of San Bernardino, 1964 Edition, and the City of San Bernardino, 1964 Edition, and the City of San Bernardino, 1964 Edition.
2. The contractor shall be responsible for obtaining all necessary permits and approvals from the City of San Bernardino.
3. The contractor shall be responsible for obtaining all necessary permits and approvals from the City of San Bernardino.
4. Sewer lines shall be constructed of either vitrified clay pipe or 12" dia. 4000 psi concrete pipe.
5. The contractor shall be responsible for obtaining all necessary permits and approvals from the City of San Bernardino.
6. The contractor shall be responsible for obtaining all necessary permits and approvals from the City of San Bernardino.

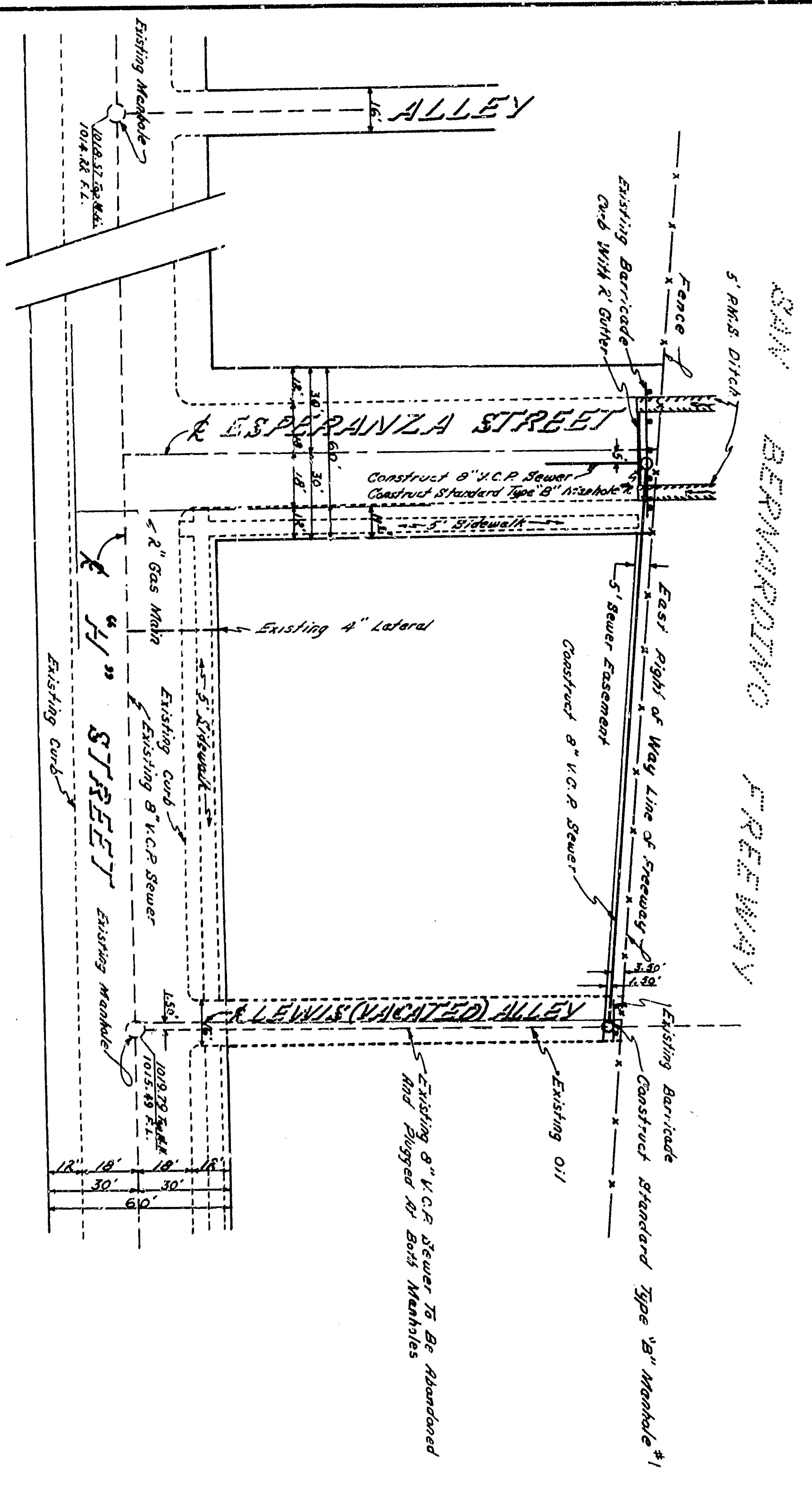

PLAN
 Scale: 1" = 40'

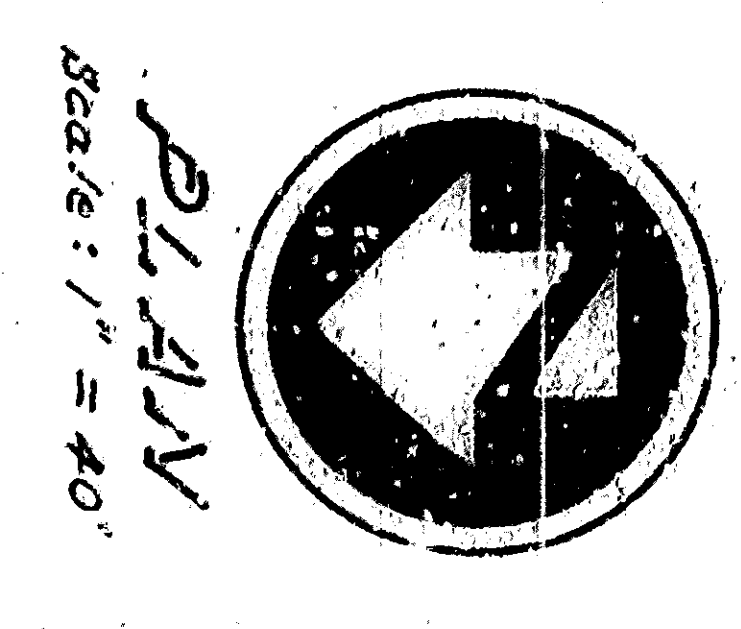
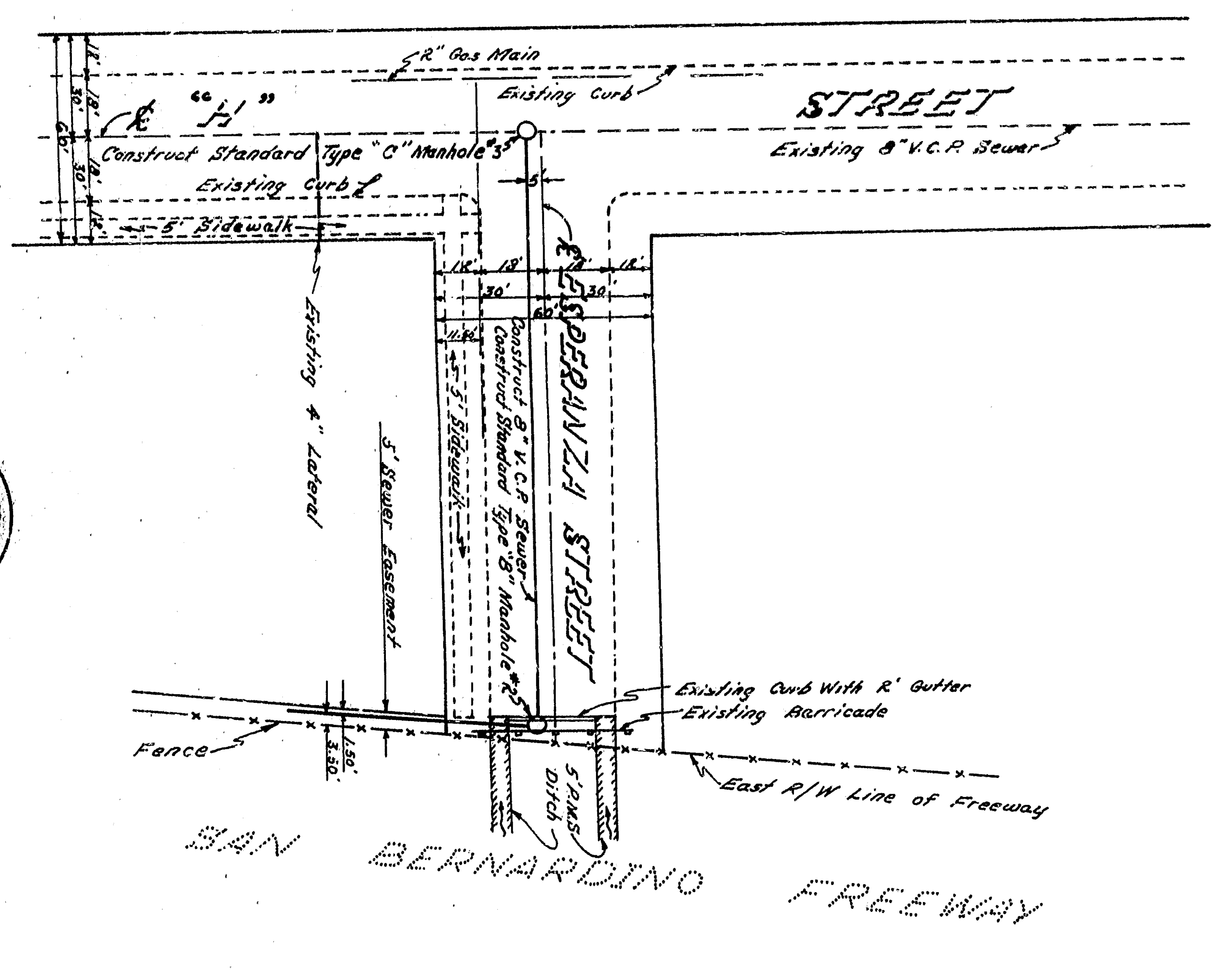

PLAN
 Scale: 1" = 40'

APPROVED	July 22, 1964
CITY ENGINEER	
REGISTERED CIVIL ENGINEER NO. 15882	
DRAWING NO. DRAWN BY	MAH
3137	
CHECKED BY	DEAN
SHEET 1 OF 1	
RECOMMENDED	

DEPARTMENT OF ENGINEERING
 CITY OF SAN BERNARDINO
 SEWER RELOCATION
 WEST OF "H" STREET
 BETWEEN
 LEWIS ALLEY & ESPERANZA STREET